

## Specifications

Current rating: 7A AC,DC  
 Voltage rating: 250V AC,DC  
 Temperature range: -40°C ~ +105°C  
 Contact resistance: 20mΩ Max.  
 Insulation resistance: 1000MΩ Min.  
 Withstanding voltage: 1500V AC/minute  
 \*Contact E.N for Details\*

## Standards



E473953

## Ordering code

C4201M - I B  
 ① ② ③④

- ① Series No.
- ② M:Male
- ③ Plating code: T=Tin-plated, G=Gold-flash
- ④ Material: B=Brass

C4201F - I B  
 ① ② ③④

- ① Series No.
- ② F:Female
- ③ Plating code: T=Tin-plated, G=Gold-flash
- ④ Material: B=Brass

C4201 HF - NP  
 ① ② ③

- ① Series No.
- ② HF=Receptacle
- ③ No. of circuits

C4201 HM - NP  
 ① ② ③

- ① Series No.
- ② HM=Plug
- ③ No. of circuits

C4201 WV 2X - NP  
 ① ② ③ ④

- ① Series No.
- ② Connector type: WV=Vertical, WR=Right angle
- ③ Blank=Single Row,2X=Dual Row
- ④ No. of circuits

### Assembly layout

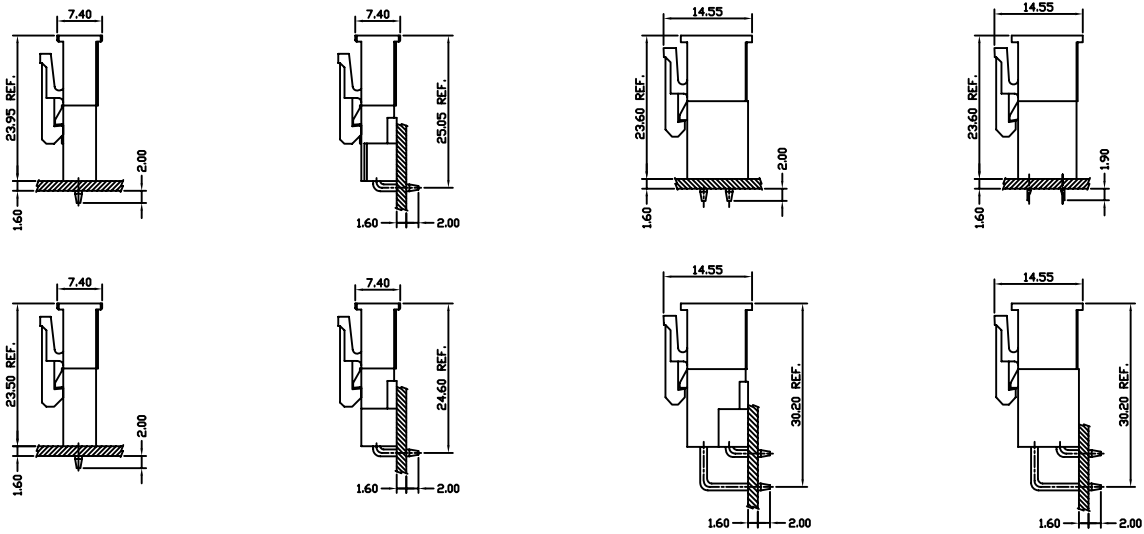

WIRE TO BOARD TYPE



WIRE TO WIRE TYPE

### Panel Hole layout

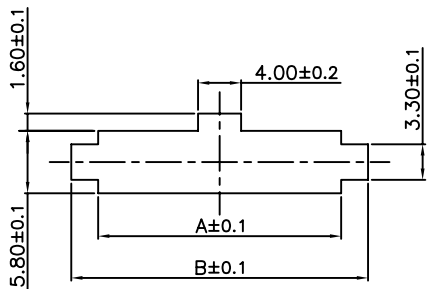

SINGLE ROW

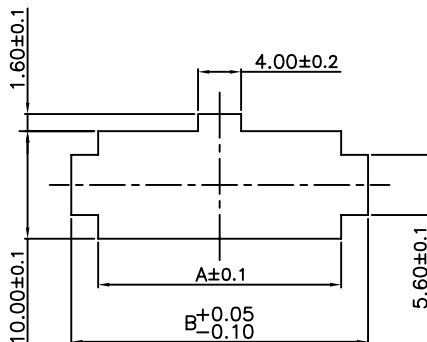

DUAL ROW

PART NO.		Dimensions	
SINGLE ROW	DUAL ROW	A	B
----	C4201HM-2X01P	5.80	10.80
C4201HM-02P	C4201HM-2X02P	10.00	15.00
C4201HM-03P	C4201HM-2X03P	14.20	19.20
C4201HM-04P	C4201HM-2X04P	18.40	23.40
C4201HM-05P	C4201HM-2X05P	22.60	27.60
C4201HM-06P	C4201HM-2X06P	26.80	31.80
C4201HM-07P	C4255HM-2X07P	31.00	36.00
C4201HM-08P	C4201HM-2X08P	35.20	40.20
C4201HM-09P	C4201HM-2X09P	39.40	44.40
C4201HM-10P	C4201HM-2X10P	43.60	48.60
C4201HM-11P	C4201HM-2X01P	47.80	52.80
C4201HM-12P	C4201HM-2X01P	52.00	57.00

Unit: mm

**C4201M-T** — 4.20mm pitch Crimp Terminal

**Reference Informations:**

\*Mates with E.N C4201HM series Housing

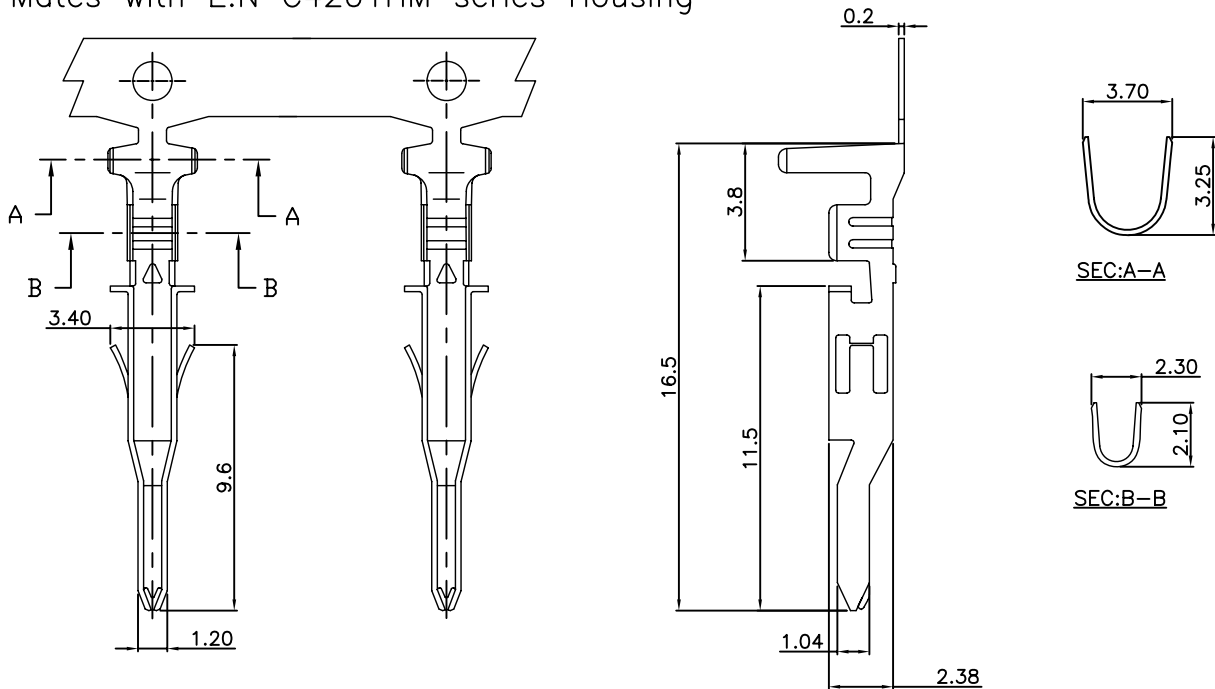

**Ordering Information & Specifications**

Unit: mm

Part No	Wire Range	Insulation O.D.	Material	Finish	Qty/reel
C4201M-TP	AWG#16-#24	3.10mm(max)	Brass	Tin-plated	5,000pcs

**C4201F-T** — 4.20mm pitch Crimp Terminal

**Reference Informations:**

\*Mates with E.N C4201 series Housing

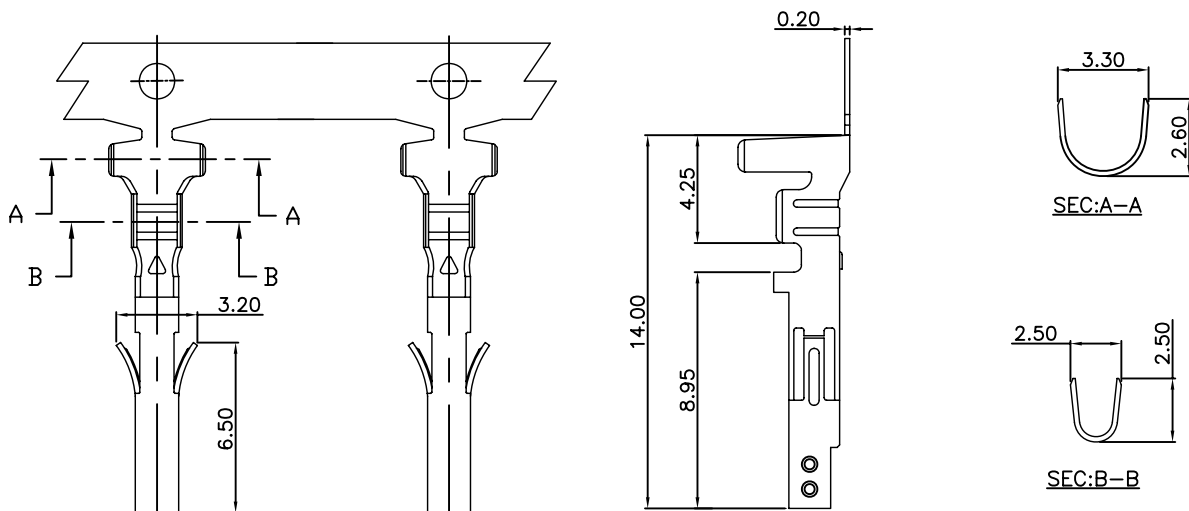

**Ordering Information & Specifications**

Unit: mm

Part No	Wire Range	Insulation O.D.	Material	Finish	Qty/reel
C4201F-TP	AWG#16-#24	3.10mm(max)	Brass	Tin-plated	5,000pcs

**C4201FG-T** — 4.20mm pitch Crimp Terminal

**Reference Informations:**

\*Mates with E.N C4201F series Housing

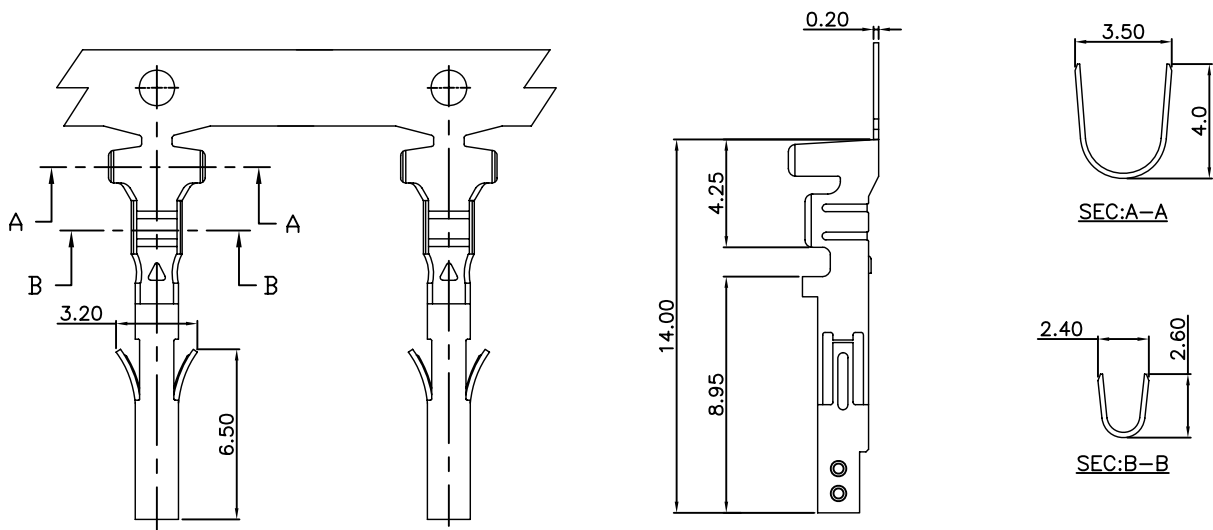

**Ordering Information & Specifications**

Unit: mm

Part No	Wire Range	Insulation O.D.	Material	Finish	Qty/reel
C4201FG-TP	AWG#16-#24	3.10mm(max)	Brass	Tin-plated	5,000pcs

## C4201HM

4.20mm pitch Housing

### Reference Informations:

- \*Material: Nylon 66,UL94V-0
- \*Suitable E.N C4201M series Terminal
- \*Mates with E.N C4201HF series Housing

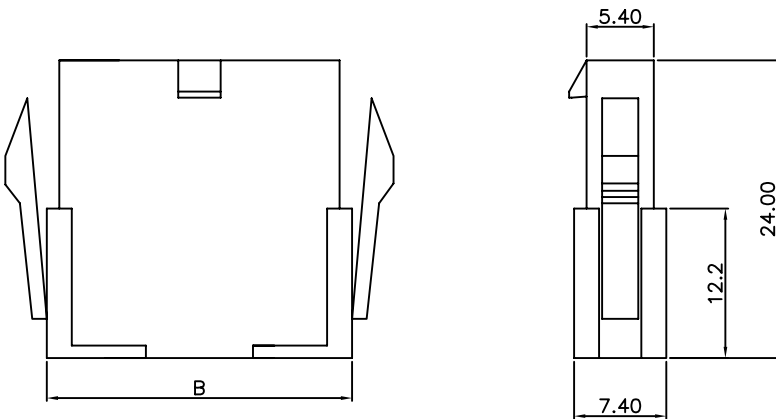
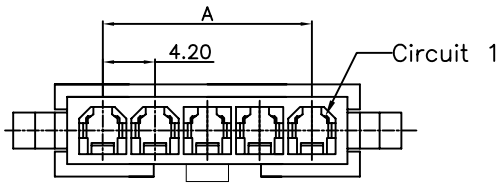
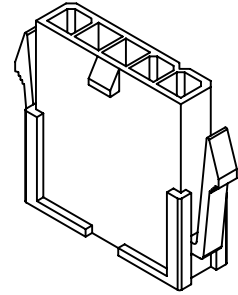

### Ordering Information & Dimensions

PART NO.	Dimensions	
	A	B
C4201HM-02P	4.20	9.60
C4201HM-03P	8.40	13.80
C4201HM-04P	12.60	18.00
C4201HM-05P	16.80	22.20

Unit: mm

## C4201HMA

4.20mm pitch Housing

### Reference Informations:

- \*Material: Nylon 66,UL94V-0
- \*Suitable E.N C4201M series Terminal
- \*Mates with E.N C4201HF series Housing

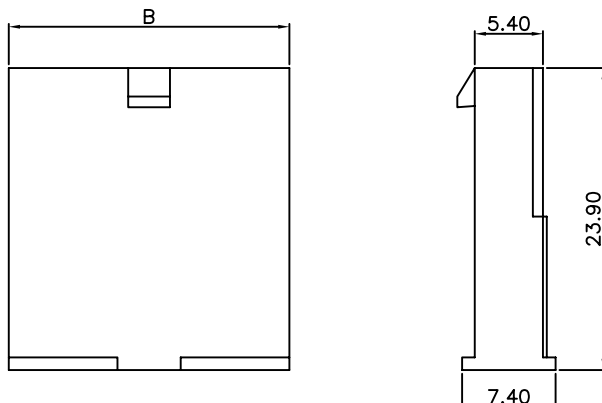
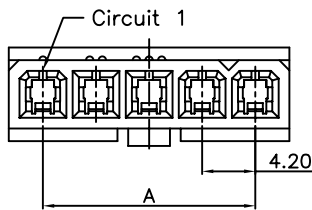
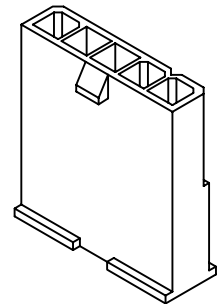

### Ordering Information & Dimensions

PART NO.	Dimensions	
	A	B
C4201HMA-02P	4.20	11.30
C4201HMA-03P	8.40	15.50
C4201HMA-04P	12.60	19.70
C4201HMA-05P	16.80	23.90

Unit: mm

## C4201HF

4.20mm pitch Housing

### Reference Informations:

- \*Material: Nylon 66,UL94V-0
- \*Suitable E.N C4201F series Terminal
- \*Mates with E.N C4201HM series Housing  
Or C4201 series Wafer

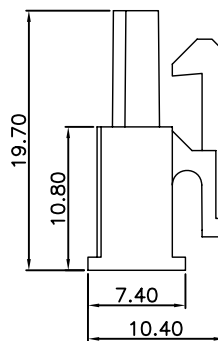
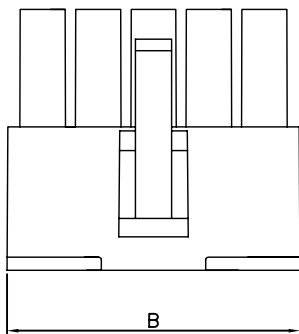
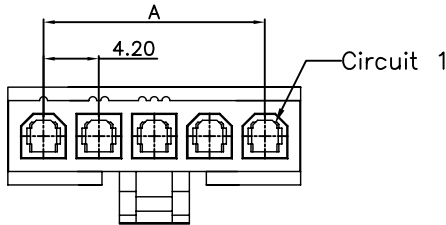
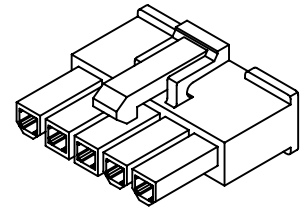

Ordering Information & Dimensions

PART NO.	Dimensions	
	A	B
C4201HF-02P	4.20	9.60
C4201HF-03P	8.40	13.80
C4201HF-04P	12.60	18.00
C4201HF-05P	16.80	22.20

Unit: mm

## C4201HM-2XNP

4.20mm pitch Housing

### Reference Informations:

- \*Material: Nylon 66,UL94V-0
- \*Suitable E.N C4201M series Terminal
- \*Mates with E.N C4201HF series Dual Row Housing

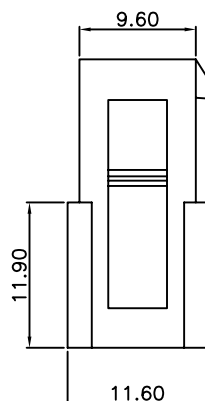
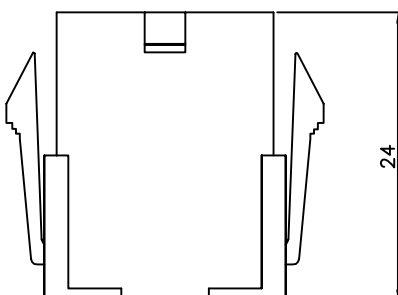
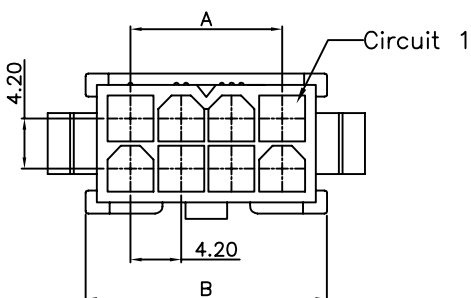
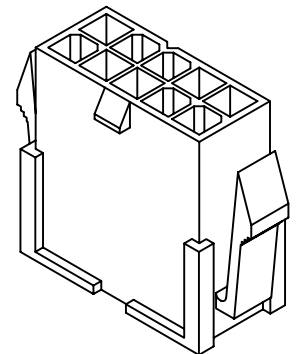

Ordering Information & Dimensions

PART NO.	Dimensions	
	A	B
C4201HM-02X01P		5.30
C4201HM-02X02P	4.20	9.50
C4201HM-02X03P	8.40	13.70
C4201HM-02X04P	12.60	17.90
C4201HM-02X05P	16.80	22.10
C4201HM-02X06P	21.00	26.30
C4201HM-02X07P	25.20	30.50
C4201HM-02X08P	29.40	34.70
C4201HM-02X09P	33.60	38.90
C4201HM-02X10P	37.80	43.10
C4201HM-02X11P	42.00	47.30
C4201HM-02X12P	46.20	51.50

Unit: mm

## C4201HMA-2XNP — 4.20mm pitch Housing

### Reference Informations:

- \*Material: Nylon 66,UL94V-0
- \*Suitable E.N C4201M series Terminal
- \*Mates with E.N C4201HF series Dual Row Housing

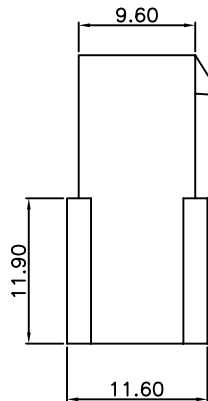
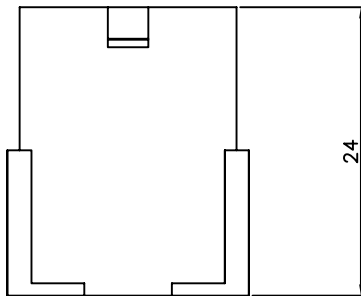
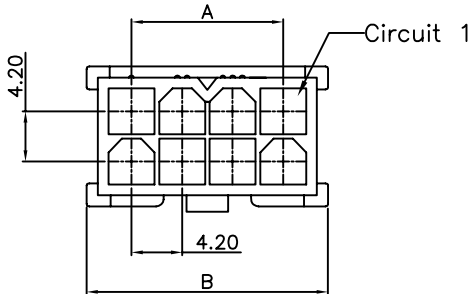
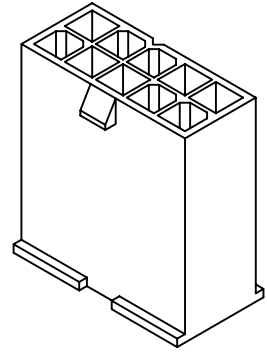

### Ordering Information & Dimensions

PART NO.	Dimensions	
	A	B
C4201HMA-02X01P	4.20	5.40
C4201HMA-02X02P	4.20	9.60
C4201HMA-02X03P	8.40	13.80
C4201HMA-02X04P	12.60	18.00
C4201HMA-02X05P	16.80	22.20
C4201HMA-02X06P	21.00	26.40
C4201HMA-02X07P	25.20	30.60
C4201HMA-02X08P	29.40	34.80
C4201HMA-02X09P	33.60	39.00
C4201HMA-02X10P	37.80	43.20
C4201HMA-02X11P	42.00	47.40
C4201HMA-02X12P	46.20	51.60

Unit: mm

## C4201HF-2XNP — 4.20mm pitch Housing

### Reference Informations:

- \*Material: Nylon 66,UL94V-0
- \*Suitable E.N C4201F series Terminal
- \*Mates with E.N C4201HM series Dual Row Housing Or C4201 series Dual Row Wafer

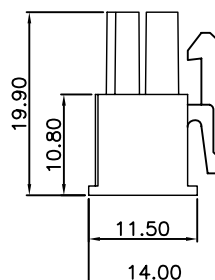
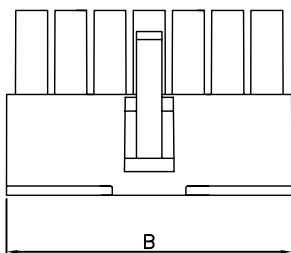
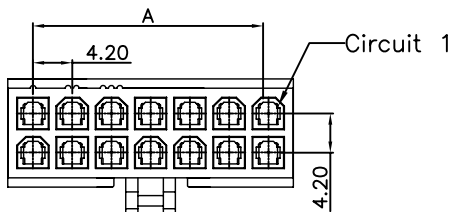
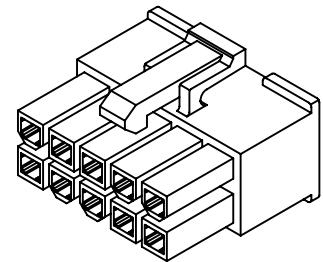

### Ordering Information & Dimensions

PART NO.	Dimensions	
	A	B
C4201HF-02X01P	4.20	5.70
C4201HF-02X02P	4.20	9.60
C4201HF-02X03P	8.40	13.80
C4201HF-02X04P	12.60	18.00
C4201HF-02X05P	16.80	22.20
C4201HF-02X06P	21.00	26.40
C4201HF-02X07P	25.20	30.60
C4201HF-02X08P	29.40	34.80
C4201HF-02X09P	33.60	39.00
C4201HF-02X10P	37.80	43.20
C4201HF-02X11P	42.00	47.40
C4201HF-02X12P	46.20	51.60

Unit: mm



## C4201WW

4.20mm pitch 180° Wafer

### Reference Informations:

- \*Material: Pin: Brass/Tin-plated  
Wafer:Nylon66,UL94V-0
- \*Mates with E.N C4201HF series Housing

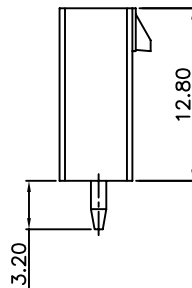
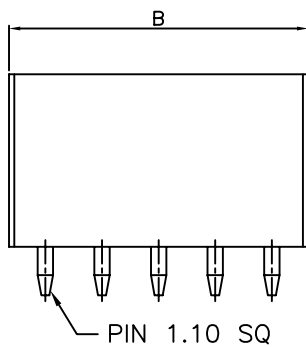
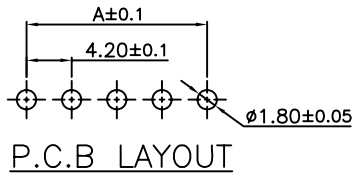
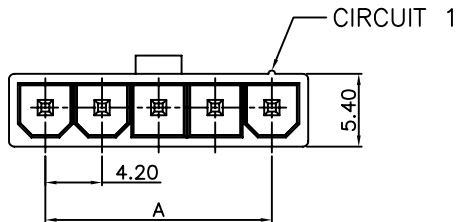
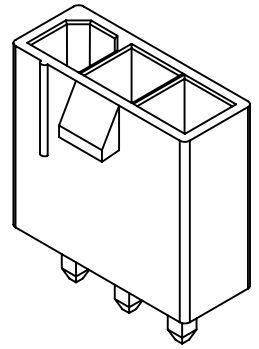

### Ordering Information & Dimensions

PART NO.	Dimensions	
	A	B
C4201WW-02P	4.20	9.60
C4201WW-03P	8.40	13.80
C4201WW-04P	12.60	18.00
C4201WW-05P	16.80	22.20

Unit: mm

## C4201WR

4.20mm pitch 90° Wafer

### Reference Informations:

- \*Material: Pin: Brass/Tin-plated  
Wafer:Nylon66,UL94V-0
- \*Mates with E.N C4201HF series Housing

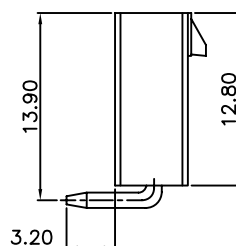
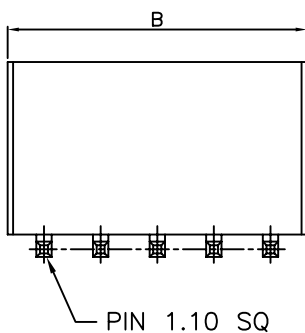
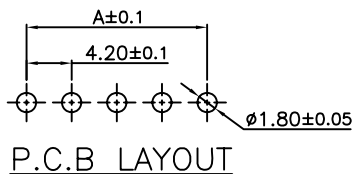
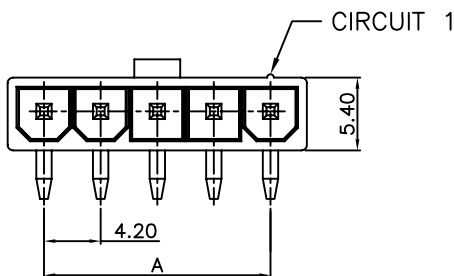
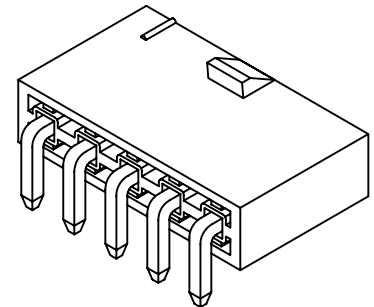

### Ordering Information & Dimensions

PART NO.	Dimensions	
	A	B
C4201WR-02P	4.20	9.60
C4201WR-03P	8.40	13.80
C4201WR-04P	12.60	18.00
C4201WR-05P	16.80	22.20

Unit: mm

## C4201WV-2XNP — 4.20mm pitch 180° Wafer

### Reference Informations:

\*Material: Pin: Brass/Tin-plated  
Wafer:Nylon66,UL94V-0

\*Mates with E.N C4201HF series Dual Row Housing

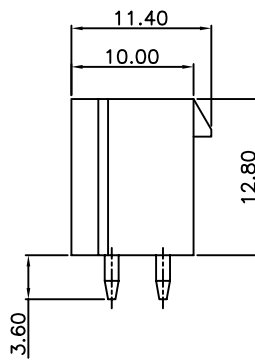
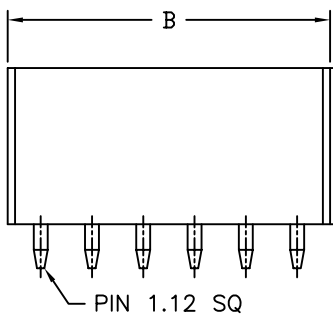
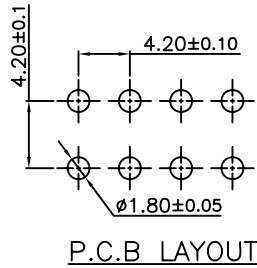
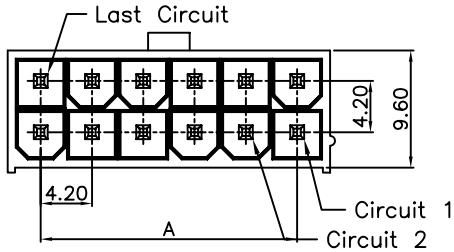
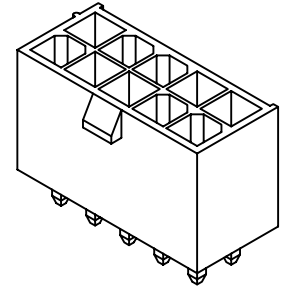

### Ordering Information & Dimensions

PART NO.	Dimensions	
	A	B
C4201WV-02X01P		5.40
C4201WV-02X02P	4.20	9.60
C4201WV-02X03P	8.40	13.80
C4201WV-02X04P	12.60	18.00
C4201WV-02X05P	16.80	22.20
C4201WV-02X06P	21.00	26.40
C4201WV-02X07P	25.20	30.60
C4201WV-02X08P	29.40	34.80
C4201WV-02X09P	33.60	39.00
C4201WV-02X10P	37.80	43.20
C4201WV-02X11P	42.00	47.40
C4201WV-02X12P	46.20	51.60

Unit: mm

## C4201WR-2XNP — 4.20mm pitch 90° Wafer

### Reference Informations:

\*Material: Pin: Brass/Tin-plated  
Wafer:Nylon66,UL94V-0

\*Mates with E.N C4201HF series Dual Row Housing

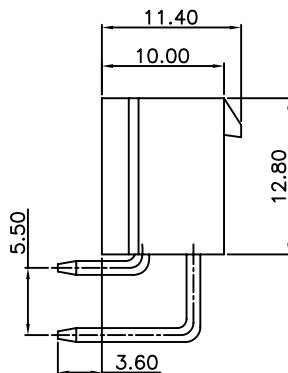
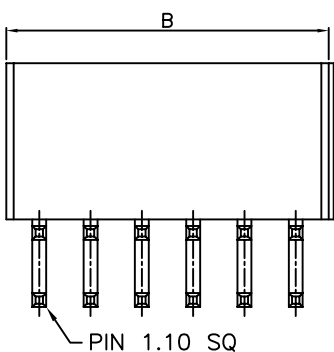
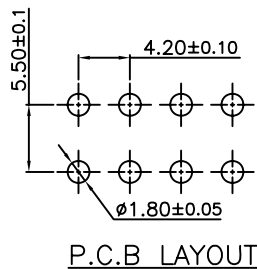
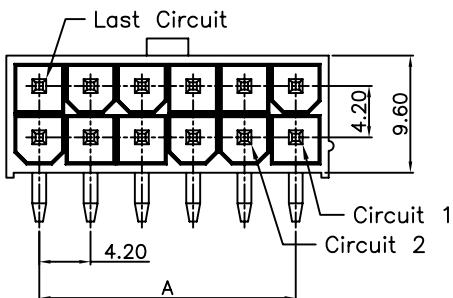
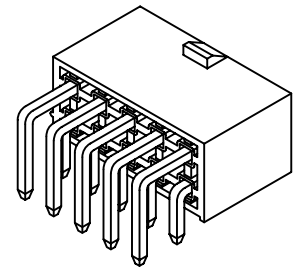

### Ordering Information & Dimensions

PART NO.	Dimensions	
	A	B
C4201WR-02X01P		5.60
C4201WR-02X02P	4.20	9.80
C4201WR-02X03P	8.40	14.00
C4201WR-02X04P	12.60	18.20
C4201WR-02X05P	16.80	22.40
C4201WR-02X06P	21.00	26.60
C4201WR-02X07P	25.20	30.80
C4201WR-02X08P	29.40	35.00
C4201WR-02X09P	33.60	39.20
C4201WR-02X10P	37.80	43.40
C4201WR-02X11P	42.00	47.60
C4201WR-02X12P	46.20	51.80

Unit: mm

## C4201WVA — 4.20mm pitch 180° Wafer

### Reference Informations:

- \*Material: Pin: Brass/Tin-plated  
Wafer: Nylon66, UL94V-0
- \*Mates with E.N C4201HF series Dual Row Housing

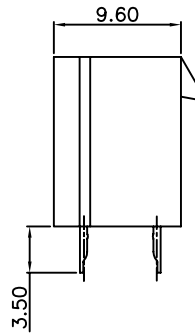
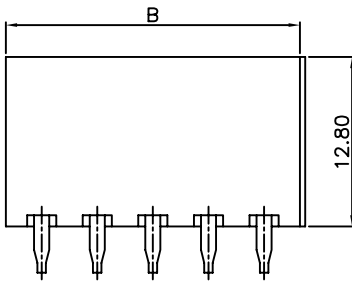
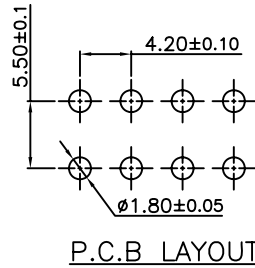
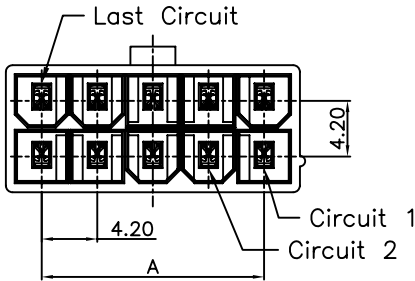
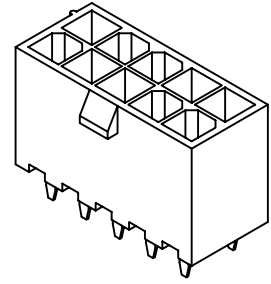

### Ordering Information & Dimensions

PART NO.	Dimensions	
	A	B
C4201WVA-02X01P	5.40	5.40
C4201WVA-02X02P	4.20	9.60
C4201WVA-02X03P	8.40	13.80
C4201WVA-02X04P	12.60	18.00
C4201WVA-02X05P	16.80	22.20
C4201WVA-02X06P	21.00	26.40
C4201WVA-02X07P	25.20	30.60
C4201WVA-02X08P	29.40	34.80
C4201WVA-02X09P	33.60	39.00
C4201WVA-02X10P	37.80	43.20
C4201WVA-02X11P	42.00	47.40
C4201WVA-02X12P	46.20	51.60

Unit: mm