

Specifications

Current rating: 7A AC,DC
 Voltage rating: 250V AC,DC
 Temperature range: -25°C ~ +85°C
 Contact resistance: 20mΩ Max.
 Insulation resistance: 1000MΩ Min.
 Withstanding voltage: 1500V AC/minute
 Contact E.N for Details

Standards



Assembly layout

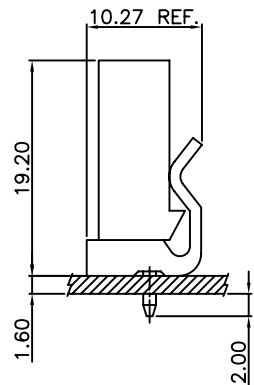
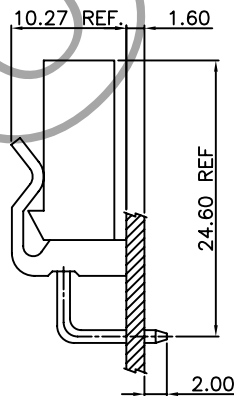
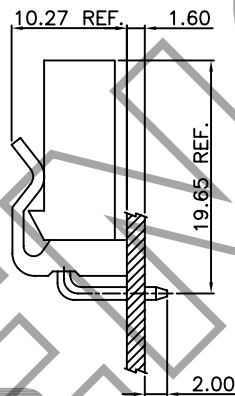

Ordering code

A3961 - I P
 ① ② ③

- ① Series No.
- ② Plating code: T=Tin-plated, G=Gold-flash
- ③ Material: P=Phosphor bronze

A3961 WR A - NP
 ① ② ③ ④

- ① Series No.
- ② Connector type: WV=Vertical, WR=Right angle
- ③ Blank=Normal type
A=A type
- ④ No. of circuits

A3961 HF - NP
 ① ② ③

- ① Series No.
- ② HF=Receptacle Housing HM=Plug Housing
- ③ No. of circuits

A3961-T 3.96mm pitch Crimp Terminal

Reference Informations:

*Mates with E.N A3961 series Housing

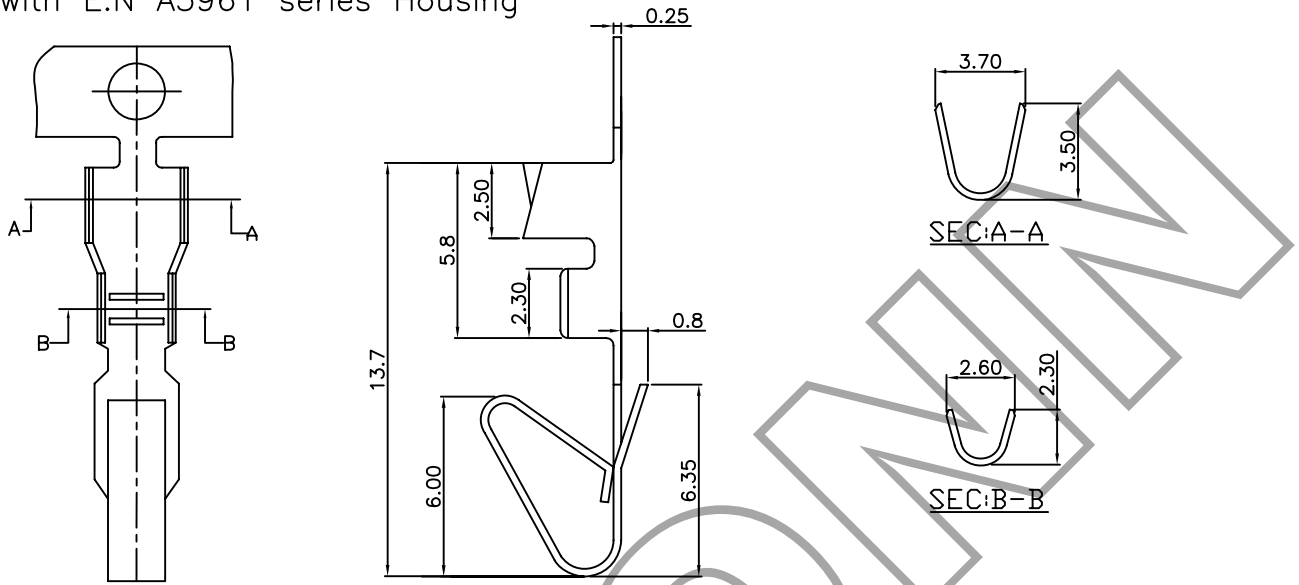

Ordering Information & Specifications

Unit: mm

Part No	Wire Range	Insulation O.D.	Material	Finish	Qty/reel
A3961-TP	AWG#22-#18	1.70mm(max)	Phosphor Bronze	Tin-plated	7,000pcs
A3961-PT	AWG#22-#18	1.70mm(max)	Phosphor Bronze	Tin-plated	7,000pcs

A3961H 3.96mm pitch Housing

Reference Informations:

- *Material: Nylon 66,UL94V-2
- *Suitable E.N A3961 series Terminal
- *Mates with E.N A3961 series Wafer

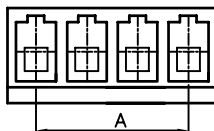
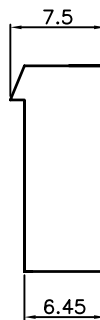
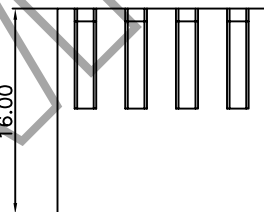
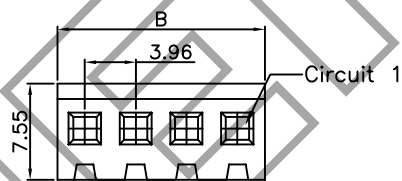
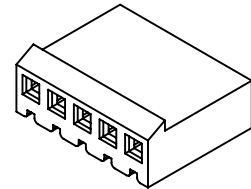

Ordering Information & Dimensions

PART NO.	Dimensions	
	A	B
A3961H-02P	3.96	8.43
A3961H-03P	7.92	12.39
A3961H-04P	11.88	16.35
A3961H-05P	15.84	20.31
A3961H-06P	19.80	24.27
A3961H-07P	23.76	28.23
A3961H-08P	27.72	32.19
A3961H-09P	31.68	36.15
A3961H-10P	35.64	40.11
A3961H-11P	39.60	44.07
A3961H-12P	43.56	48.03
A3961H-13P	47.52	51.99
A3961H-14P	51.48	55.95
A3961H-15P	55.44	59.91
A3961H-16P	59.40	63.87
A3961H-17P	63.36	67.83
A3961H-18P	67.32	71.79

Unit: mm

A3961WR — 3.96mm pitch 90° Wafer

Reference Informations:

- *Material: Pin: Brass/Tin-plated
Wafer: Nylon66,UL94V-0
- *Mates with E.N A3961 series Housing

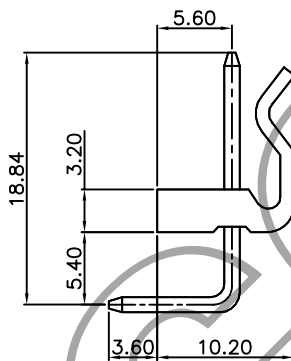
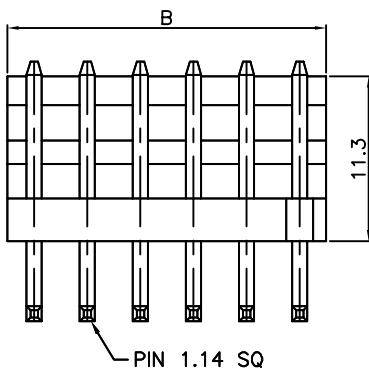
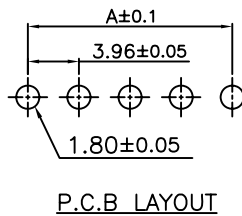
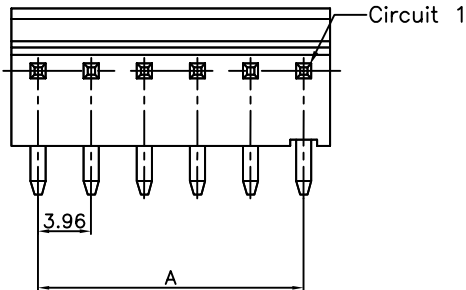
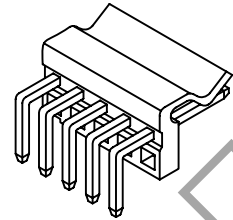

Ordering Information & Dimensions

PART NO.	Dimensions	
	A	B
A3961WR-02P	3.96	7.92
A3961WR-03P	7.92	11.88
A3961WR-04P	11.88	15.84
A3961WR-05P	15.84	19.80
A3961WR-06P	19.80	23.76
A3961WR-07P	23.76	27.72
A3961WR-08P	27.72	31.68
A3961WR-09P	31.68	35.64
A3961WR-10P	35.64	39.60
A3961WR-11P	39.60	43.56
A3961WR-12P	43.56	47.52
A3961WR-13P	47.52	51.48
A3961WR-14P	51.48	55.44
A3961WR-15P	55.44	59.40
A3961WR-16P	59.40	63.36
A3961WR-17P	63.36	67.32
A3961WR-18P	67.32	71.28

Unit: mm

A3961WVR — 3.96mm pitch 90° Wafer

Reference Informations:

- *Material: Pin: Brass/Tin-plated
Wafer: Nylon66,UL94V-0
- *Mates with E.N A3961 series Housing

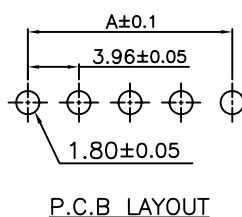
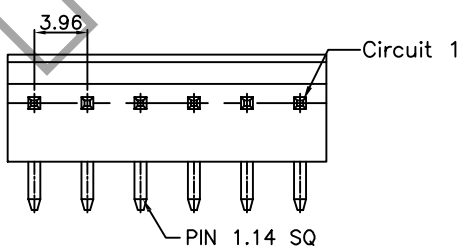
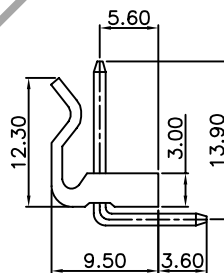
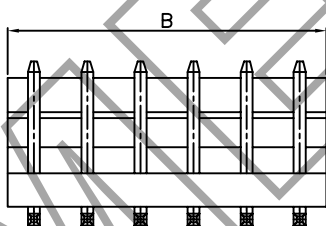
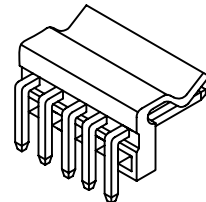

Ordering Information & Dimensions

PART NO.	Dimensions	
	A	B
A3961WVR-02P	3.96	7.92
A3961WVR-03P	7.92	11.88
A3961WVR-04P	11.88	15.84
A3961WVR-05P	15.84	19.80
A3961WVR-06P	19.80	23.76
A3961WVR-07P	23.76	27.72
A3961WVR-08P	27.72	31.68
A3961WVR-09P	31.68	35.64
A3961WVR-10P	35.64	39.60
A3961WVR-11P	39.60	43.56
A3961WVR-12P	43.56	47.52
A3961WVR-13P	47.52	51.48
A3961WVR-14P	51.48	55.44
A3961WVR-15P	55.44	59.40
A3961WVR-16P	59.40	63.36
A3961WVR-17P	63.36	67.32
A3961WVR-18P	67.32	71.28

Unit: mm

A3961WV — 3.96mm pitch 180° Wafer

Reference Informations:

- *Material: Pin: Phosphor Bronze/Tin-plated
Wafer: Nylon66,UL94V-0
- *Mates with E.N A3961 series Housing

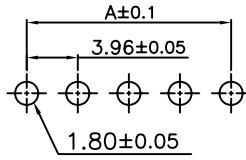
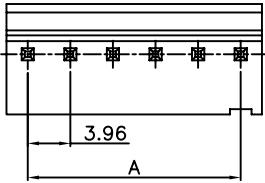
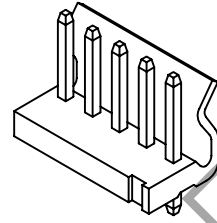

P.C.B LAYOUT

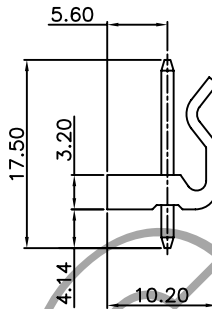
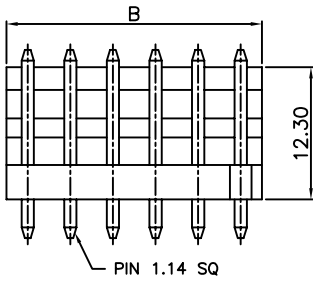

Ordering Information & Dimensions

PART NO.	Dimensions	
	A	B
A3961WV-02P	3.96	7.92
A3961WV-03P	7.92	11.88
A3961WV-04P	11.88	15.84
A3961WV-05P	15.84	19.80
A3961WV-06P	19.80	23.76
A3961WV-07P	23.76	27.72
A3961WV-08P	27.72	31.68
A3961WV-09P	31.68	35.64
A3961WV-10P	35.64	39.60
A3961WV-11P	39.60	43.56
A3961WV-12P	43.56	47.52
A3961WV-13P	47.52	51.48
A3961WV-14P	51.48	55.44
A3961WV-15P	55.44	59.40
A3961WV-16P	59.40	63.36
A3961WV-17P	63.36	67.32
A3961WV-18P	67.32	71.28

Unit: mm